

F Series Fan Instructions

FL 107, FL107/90, FL 150, FL 204, FL 250, FL 325

Mounting Instructions

1. Cut the mounting hole (as required) in the enclosure using the dimensions shown next page, respecting the tolerances indicated.
2. Insert the fan filter into the mounting hole. Note: the bottom side is marked by the logo plate down on the right.
3. Push on each corner of the cover so that the fan filter is correctly clamped.

Attention: Press on the fan filter up to the required depth so that the clips return to their original position. Fix the fan filter using the clips provided or four screws in each corresponding hole within the corners of the base.

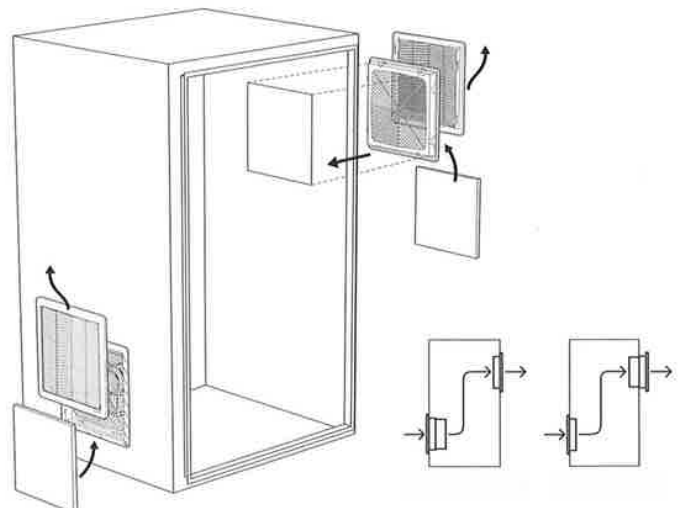
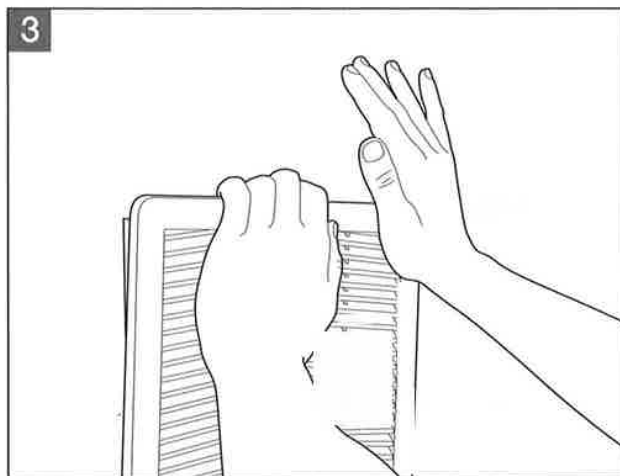
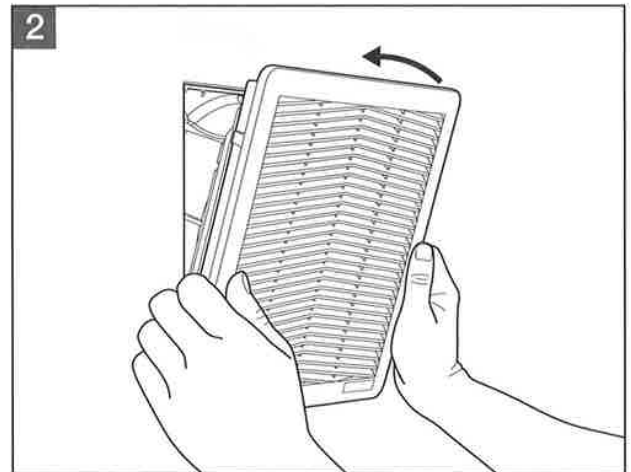
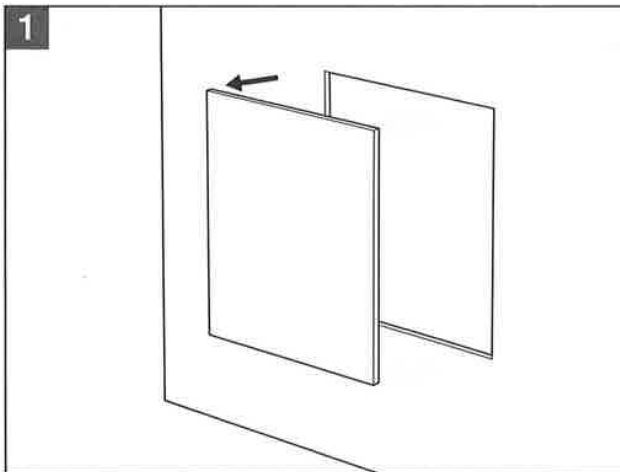

Mounting Hole Dimensions

FL 107 Cut out

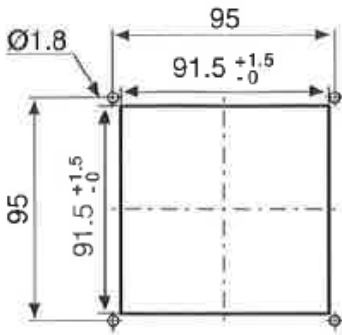

FL 107/90 Cut out

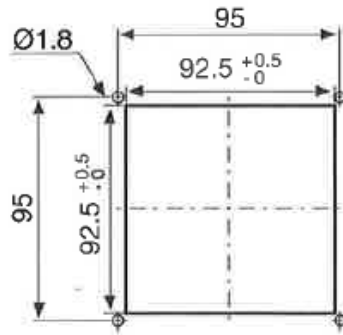

FL 150 Cut out

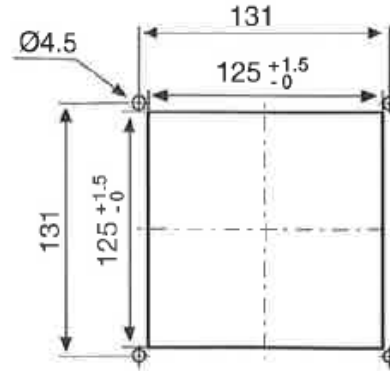

FL 204 Cut out

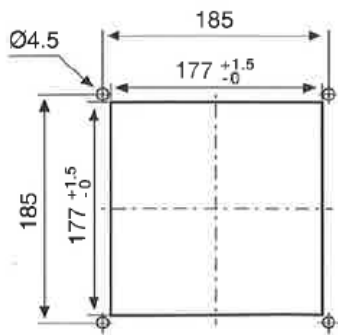

FL 250 Cut out

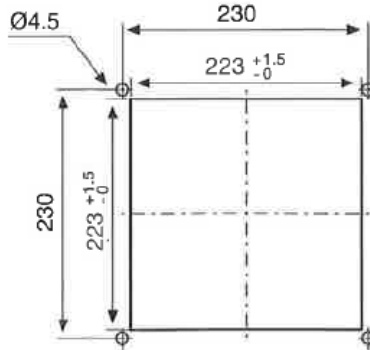

FL 325 Cut out

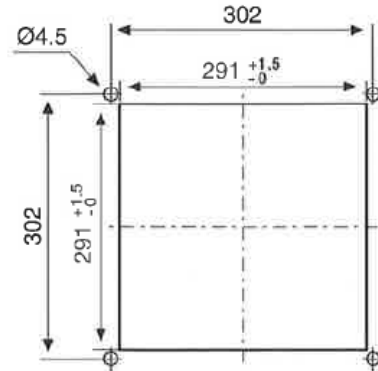

Screen Dimensions

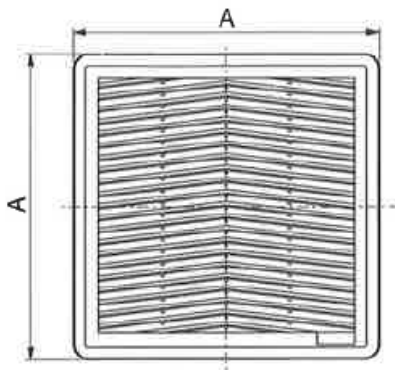

Model	A (mm)	Plate thickness (mm)
F 107, FL 107, FL 107/90	107	minimum 1 - maximum 2
F 150, FL 150	150	minimum 1 - maximum 2.1
F 204, FL 204	204	minimum 1 - maximum 2.1
F 250, FL 250	250	minimum 1 - maximum 2.5
F 325, FL 325	325	minimum 1 - maximum 2.5

Fan Filters - electrical connection of the fan filters

The voltage and frequency must be according to the rated values stated on the label.

The electrical connection must be carried out according to the local standards and safety regulations which govern the use of electrical material.

Electrical connection and repairs must be carried out by qualified personnel.

Replacement and cleaning of the filter media

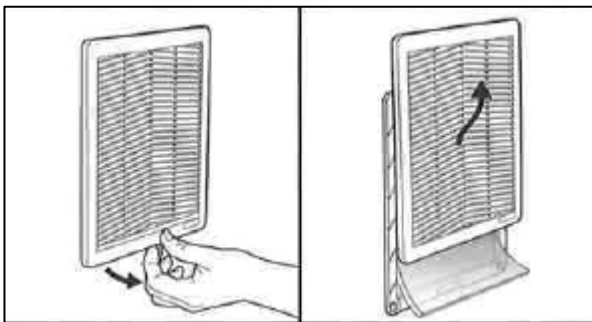

- To remove the filter, slide the cover on the base by raising the bottom and pushing it upwards
- Re-insert the cover into the base after cleaning the filter
- The filter can be cleaned by rinsing, spraying or beating
- The frequency with which the filter must be replaced depends on the amount of dust accumulated, operating period, and specific working conditions encountered by the user

Note: an unclean filter reduces the efficiency of the fan-filter casing insufficient or finally a total lack of ventilation.

Dismounting

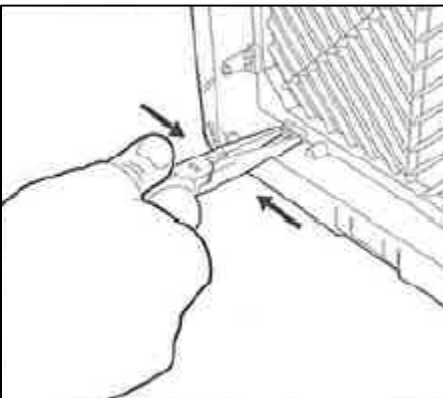

If the filter or the fan filter cannot be removed from its seat, please follow the instructions below:

Filter - using fine-nosed pliers, apply light pressure to the clips while pushing inwards towards the enclosure. This will release the clips from the base.

Fan filter - remove the fan and follow the instructions for the filter dismounting.