

“HANDY-CUT” Compact DIN Rail Cutter

The HANDY-CUT DIN Rail cutter has been specially designed for small and medium panel shops, OEMs, contractors and control/automation specialists who require an economical, portable tool and who primarily use the popular TS35 (35x7.3x1mm) mounting rail.

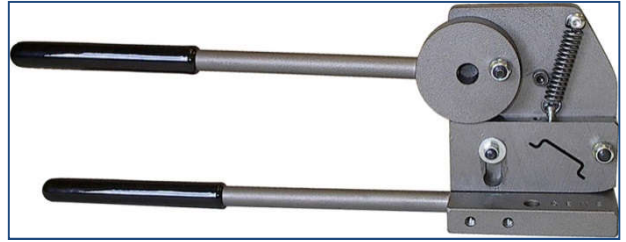

The HANDY-CUT machine has been designed for cutting standard steel profiles (common steel). It is not recommended for use in cutting aluminum, copper or stainless steel profiles. HANDY-CUT machines provide fast, clean, straight cuts of standard DIN-rails. Every piece of rail cut with this tool will be burr-free, with no deformation of the DIN rail.

The cutting edges of the dies are designed to cut all brands of TS35 rail provided they are manufactured according to the established Standards (EN 60715 / DIN 46277-3).

The HANDY-CUT cutting machine does not require permanent installation on a workbench. Thanks to the generously sized handles and lightweight design, it can be used as a portable tool requiring two-hand operation. However, two holes in the base of the machine enable it to be mounted on a bench, if so desired (mounting screws not provided).

To best operate the machine, leave ample space at least on one side of the machine, to allow insertion of a bar of DIN-rail. Please remember that DIN-rails are generally supplied in 2m (~79") bars. Also consider the space needed for free motion of the operating lever (approx. 400mm = ~16").

An available rail-guide with an end stop makes repetitive cuts of the same length easy (consult ITC). Please note that when the rail-guide is installed on the DIN-rail cutting machine, it is advised to permanently mount the entire unit on a level bench, ensuring that it has been secured **perfectly flat** on its base.

The operation of the manual DIN rail cutting machine is extremely simple and fast. Slide the rail through the guide plate and through the dies to the required length, and then operate the machine by compressing the two handles with a single smooth movement. As there is no risk of jamming the dies in any way, the machine can be used to trim the rail even for a very “short” cut.

Specifications

- **Dimensions:** Length: 340mm (~13 3/8")
Width: 70mm (~2 3/4")
Height: 120mm (~4 3/4")
- **Weight:** 2.6 kg (~5 lb.)

Maintenance

The cutting machine is sufficiently robust and does not require any special maintenance. However, in order to guarantee its functionality and durability, the following measures are recommended:

- After every day's use, the cutting machine should be cleaned with a cloth, removing any dirt, especially from the moving parts and the dies. Wipe off any liquids or moisture
- Regularly oil the mechanical moving parts and the dies
- The machine does not, in principle, need re-sharpening. However, should such procedure be required, do not attempt to disassemble the machine and sharpen the dies yourself, unless you are skilled in tool making and maintenance

“HANDY-CUT” Parts Inventory and diagram:

510.801-01	Vinyl Handle Grip
510.801-02	Complete Handle New Model
510.801-03	Nut/Bolt/Washer Set for Cam
510.801-04	Sliding Nut/Bolt/Washer Set for Dies
510.801-05	Base Unit
510.801-06	Fixed Nut/Bolt/Washer Set for Dies
510.801-07	Screw/Spacer Set for Entry Guide Plate
510.801-08	Entry Guide Plate
510.801-09	Return Spring
510.801-10	Fixing Bolt for Return Spring
510.801-11	Cam Limiting Bolt
510.801-12	Fixed Die Plate
510.801-14	Fixing Screw Pin for Return Spring
510.801-15	Operating Die Plate

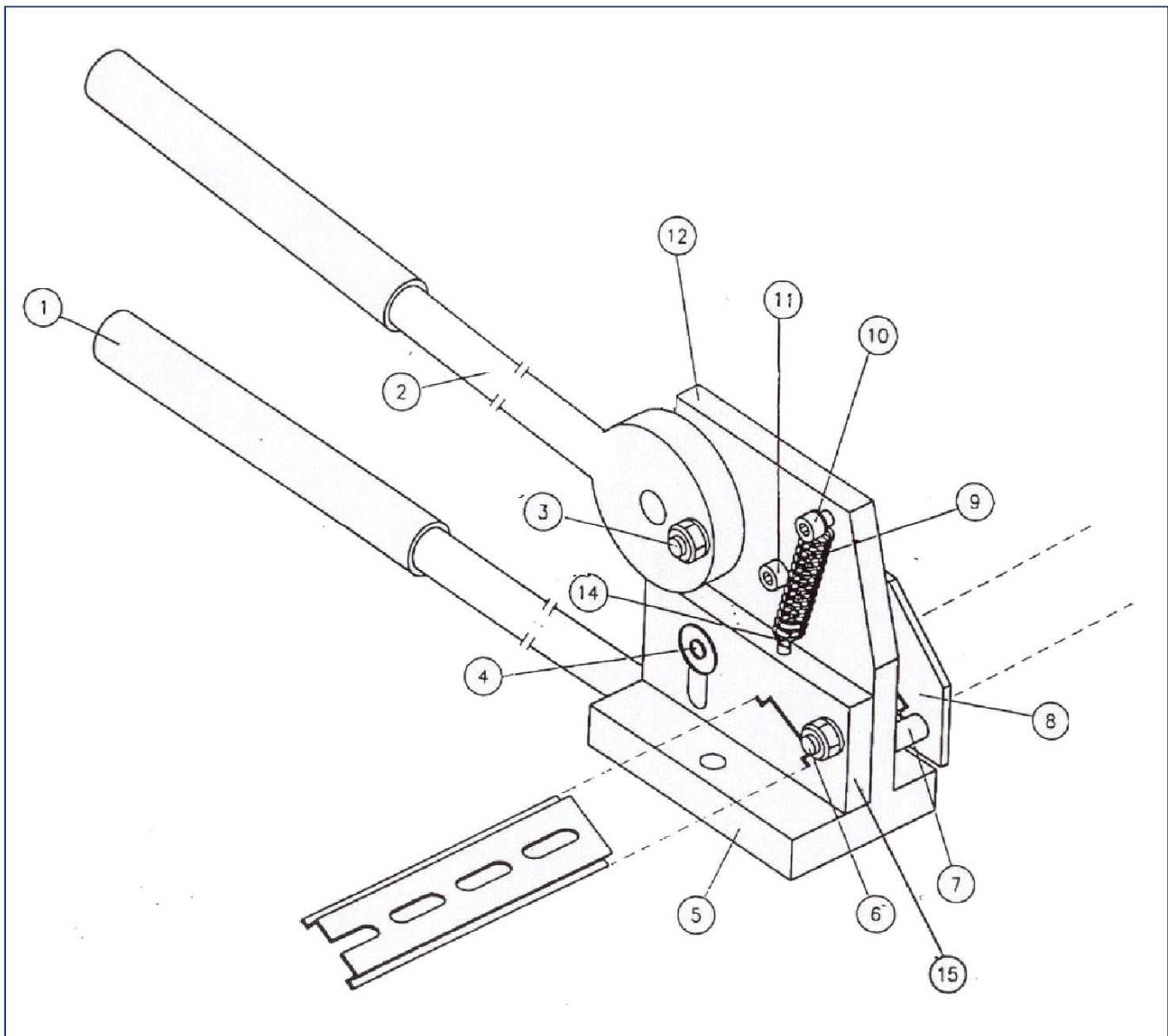

DIN Rail

Standard DIN rail is made of cold rolled steel, electrolytically plated with minimum coating thickness of 6µ (RoHS compliant). Mounting holes, for steel slotted models, are punched after cold rolling, in order to guarantee the dimensional tolerance and consistency in hole sizing and spacing.

The standard supply length is 2m (approx. 78 3/4"), and some are also available in 1m (approx. 39 3/8") lengths.

DIN Standard 35mm (symmetric) Mounting Rail

- Construction as per the EN 60715 Standard
- Dimension: 35x7.5mm
- Thickness: 1.0mm [except TS35AL/F4 - thickness 1.5mm]

All DIN standard 35mm symmetric rails by ITC (except TS35AL/F4) can be cut / punched with the following DIN Cutting tools:

Part No. DIN Cutter	Equipped with:	Punching
510.300	M32 Die p/n 510.352	Yes
510.320	M32 Die p/n 510.352	Yes
510.501	-	Yes
510.520	-	No
510.601	-	Yes

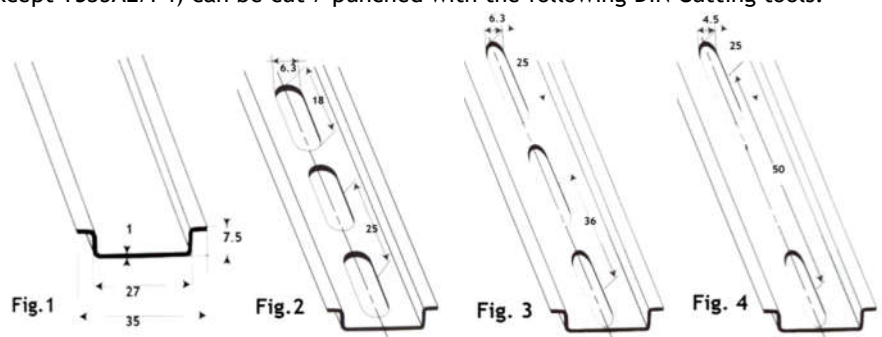

DIN Standard 35mm (symmetric) Mounting Rail (order by part number):

Part No.	Model	Description	Length (m)	Weight per m (kg)	Standard Pack (m)	Weight per pack (kg)	Figure
111.010	TS35m	Symmetric steel rail, non-punched, zinc plated (RoHS compliant)	1m	0.35	20m	7.00	1
111.011	TS35	Symmetric steel rail, non-punched, zinc plated (RoHS compliant)	2m	0.35	40m	14.00	1
111.013	TS35/F6	Symmetric steel rail, punched 6.3x18mm pitch 25mm, zinc plated (RoHS compliant)	2m	0.315	40m	12.60	2
111.018	TS35P/F4	PVC rail, punched 4.5 x25mm, pitch 50mm, grey	2m	0.11	10m	1.10	4
111.019	TS35Cu	Copper rail, non punched, non plated	2m	0.55	4m	2.20	1
111.020	TS35/F6m	Symmetric steel rail, punched 6.3x18mm pitch 25mm, zinc plated (RoHS compliant)	1m	0.315	20m	6.30	2
111.023	TS35/F5	Symmetric steel rail, punched 5.1x25mm pitch 36 mm, zinc plated (RoHS compliant)	2m	0.32	40m	12.80	3
111.033	TS35AL/F4	Aluminum rail, punched 4.5x25mm pitch 50 mm, thickness 1.5mm	1m	0.25	20m	5.00	4
111.036	TS35AL	Aluminum rail, non punched, thickness 1mm	2m	0.24	20m	4.80	1
111.037	TS35SS/F6	Stainless steel rail, punched 6.3x18mm, pitch 25mm	2m	0.32	4m	1.25	2

Information subject to change without notice - All dimensions in mm except where noted



WARRANTY

ITC Inc. warrants this Product to be free from defects in material and workmanship and agrees to remedy any such defect. This warranty covers 1 year Parts and Labor from the date of purchase by the original purchaser.

This warranty is conditional upon the Product being installed and used as directed in the instruction manual.

ITC's obligation under this warranty shall be limited to the repair, including all necessary parts and the cost of the shop labor connected therewith, or at ITC's option, the exchange of any Product which shows evidence of a manufacturing defect within the warranty period. Replacement parts, furnished under this warranty shall be warranted for a period equal to the unexpired portion of the original equipment warranty.

Parts may be replaced under this warranty with new or comparable remanufactured parts.

This warranty does not cover damage from abuse, neglect, or any other use not found in the printed instructions.

This warranty does not apply to the external appearance of this Product, and shall, in addition, not apply to customer adjustments that are not covered in the instruction manual; damages due to handling, transportation, unpacking, set-up, installation, repair or replacement of parts supplied by other than ITC authorized service personnel; or any malfunction or failure caused by or resulting from abnormal environmental conditions, improper service, improper maintenance, modifications or repair by the consumer, accident, fire, flood, or any other Acts of God.

This warranty becomes void in the event of rental use of this Product. This warranty becomes void in the event serial numbers are altered, defaced or removed.

This warranty does not apply outside Canada. ITC Inc. disclaims all responsibilities for consequential damages or incidental losses caused by the use of this product.

If you have a claim under this warranty, please contact our Customer Service:
Tel: (416)663-7223 | Fax: (416)663-7224 | e-mail: sales@itcproducts.com

CUSTOMER RECORD

Company: _____
Address: _____
City: _____ Prov.: _____ Postal Code: _____
Model No.: _____ Serial No.: _____

Date of Purchase _____

Distributor's Name: _____
Address: _____
City: _____ Prov.: _____ Postal Code: _____

WDS99R05-1